

WEST SUSSEX COUNTY COUNCIL
((CRAWLEY BOROUGH) (PARKING PLACES AND TRAFFIC REGULATION)
(CONSOLIDATION) ORDER 2010)
(HAZELWICK SCHOOL CLOSE MINOR AMENDMENT)
ORDER 2017

CRAWLEY: LOCATION OF WAITING RESTRICTIONS

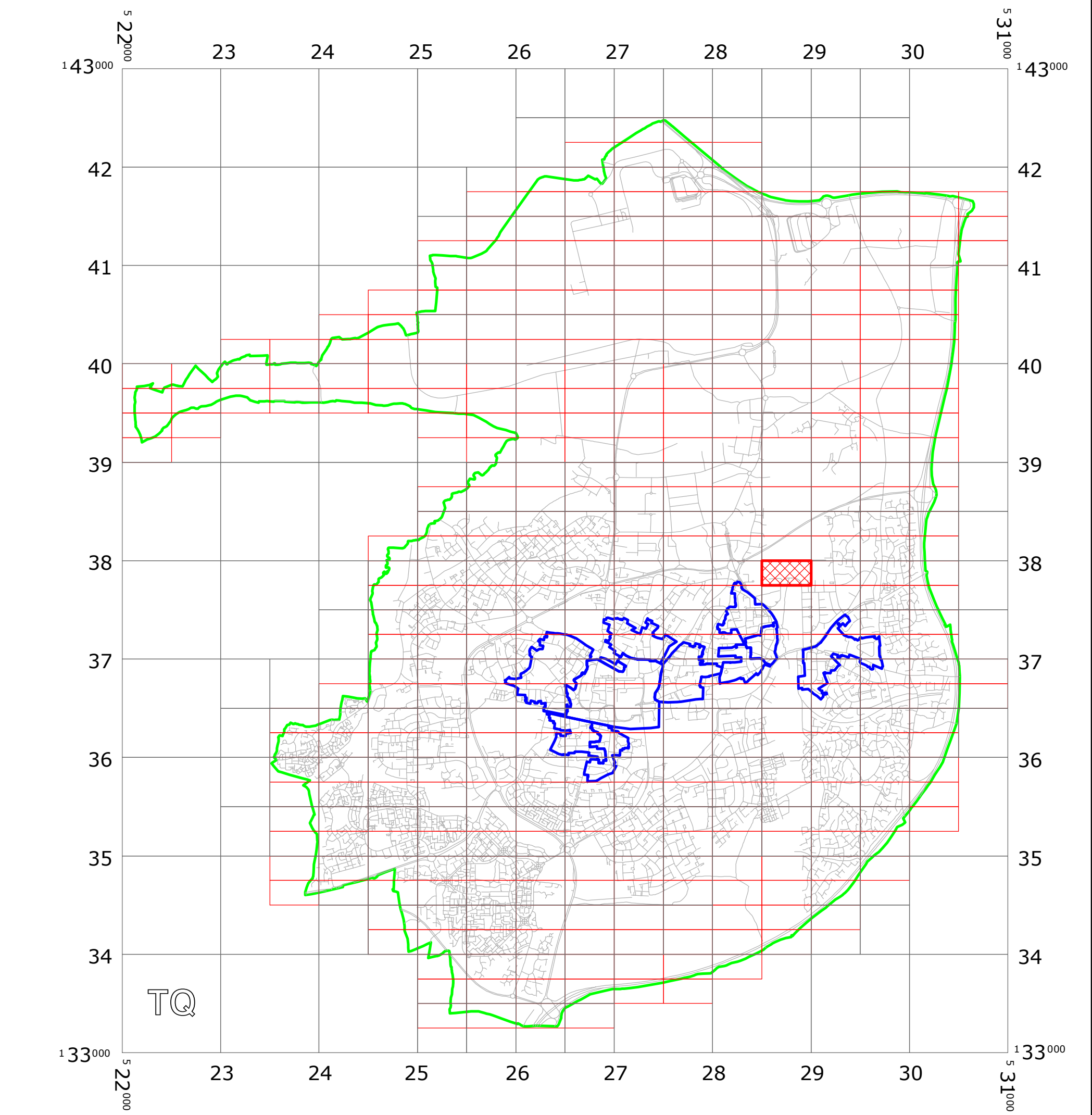

KEY:

OS.TILE GRID

PARKING TILE GRID

LOCATION OF WAITING RESTRICTIONS

PARISH BOUNDARY

CONTROLLED PARKING ZONE BOUNDARY

ROAD NETWORK

Key for Waiting Restrictions

All areas over which the provision of the orders apply are defined by the shaded areas as shown on the following plans plus a contiguous area not indicated on the plans of verge and/or footway between the carriageway edge and the highway boundary. The plans in this schedule are based upon grid references of the Ordnance Survey National Grid defined by the OSGB 36 triangulation.

Prohibition of waiting at any time

101		check	No waiting at any time
-----	-----------------------------------------------------------------------------------	-------	------------------------

Clearways (yellow 255-255-0)

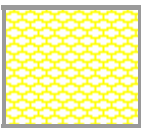
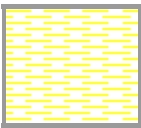
1100		usgs503	School Keep Clear-No stopping at any time
1104		usgs620	Bus stop clearway 7.00am-7.00pm any day

WEST SUSSEX COUNTY COUNCIL
((CRAWLEY BOROUGH) (PARKING PLACES AND TRAFFIC REGULATION)
(CONSOLIDATION) ORDER 2010)
(HAZELWICK SCHOOL CLOSE MINOR) ORDER 2017

West Sussex County Council in exercise of their powers under Sections 1 (1) 2 (1) and (2), 4 (2), 45, 46, 49 and 53 and Part IV of Schedule 9 of the Road Traffic Regulation Act 1984 "the Act" as amended and of all other enabling powers and after consultation with the chief officer of police in accordance with Part III of Schedule 9 to the Act hereby make the following Order:-

1. This Order shall come into operation on the 14th day of December 2017 and may be cited as "West Sussex County Council ((Crawley Borough) (Parking Places and Traffic Regulation) (Consolidation) Order 2010) (Hazelwick School Close Minor) Order 2016."
2. The "West Sussex County Council (Crawley Borough) (Parking Places and Traffic Regulation) (Consolidation) Order 2010" is hereby amended by the deletion from it of the plan specified in the First Schedule to this Order and the substitution of the plan attached in the Second Schedule to this Order.

FIRST SCHEDULE
Plan to be deleted

TQ2837NEN (Sheet Issue No. 3)

SECOND SCHEDULE
Plan to be substituted
(as attached)

TQ2837NEN (Sheet Issue No. 4)

THE COMMON SEAL of WEST SUSSEX
COUNTY COUNCIL was hereto affixed

the TWENTY EIGHTH day of NOVEMBER 2017
in the presence of:) (L.S)

Authorised Signatory





4/18 DELEGATED AUTHORITY

I HEREBY CERTIFY THIS TO
BE A TRUE COPY OF THE
ORIGINAL DOCUMENT

.....
Authorised Officer

WEST SUSSEX COUNTY COUNCIL



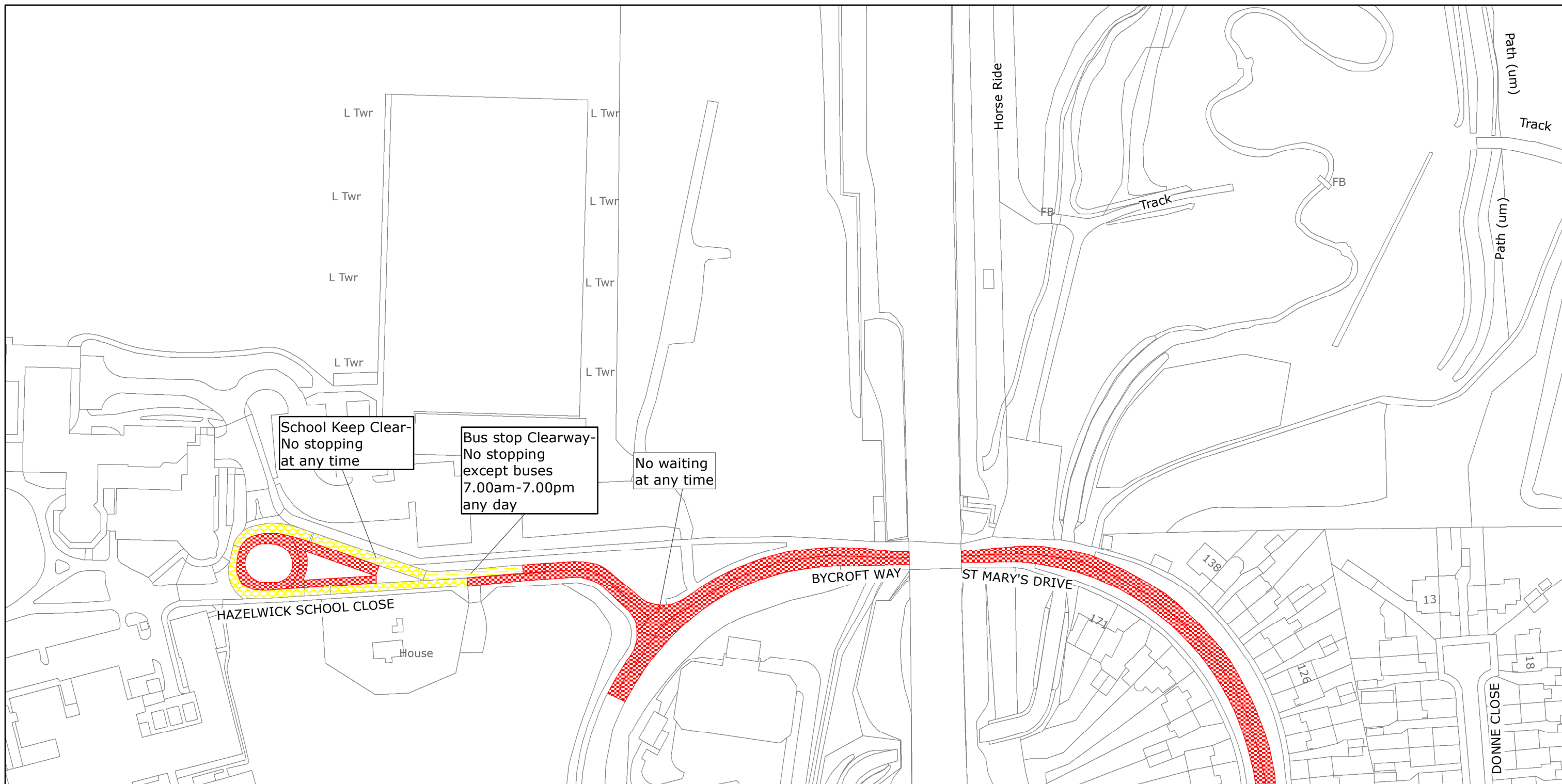

West Sussex County Council
Highways & Transport
The Grange
Tower Street
Chichester
West Sussex
PO19 1RH

CRAWLEY BOROUGH: POUND HILL NORTH AND
THREE BRIDGES WARDS

WAITING RESTRICTIONS

Reproduced from or based upon 2017 Ordnance Survey mapping with permission of the Controller of HMSO (c) Crown Copyright reserved.
Unauthorised reproduction infringes Crown copyright and may lead to prosecution or civil proceedings West Sussex County Council Licence No. 100018485

TILE REF NO:
TQ2837NEN

SHEET ISSUE NO 4

SHEET ACTIVE FROM - 14/12/2017



SCALE:
1:1250
at A3 size